



# Testing Space

A unique creative space in the heart of Southampton's  
artist community



# About

As part of 'a space' arts Artist Resources Programme, Testing Space is a multi-functional space dedicated to facilitating creative opportunities and empowering Southampton's artist community.

Located in the Arches Studios, 'a space' arts managed studio complex of 21 studios and home to a vibrant community of artists, Testing Space has been designed for visual artists and art workers living and/or working in Southampton to experiment with new work and the development of ideas.

As a large and flexible space that offers a variety of functions and facilities, artists are able to use the Testing Space to develop and produce new works, host a pop-up exhibition or event, and build meaningful connections with other studio holders and artists in the local community to make an impact on the city's arts scene.

# Testing Space

“The space itself is fantastic as it is calm and private...The whole experience has been so positive and I feel I achieved more than I had hoped. I now see where I want to develop the work creatively and where I need to do some more research to support this.”



# Our mission

‘a space’ arts recognises the barriers artists face in having access to a dedicated workspace for their creative practice and to experiment with new ideas.

In our continued commitment to providing greater accessibility and opportunities for all of Southampton’s visual artist community to develop their practice, we are pleased to offer the Testing Space to artists and art workers living and/or working in the Southampton postcode area at no cost, for a period of up to 21 days.

## Uses of Testing Space

The Testing Space is a flexible and versatile space that can be used to suit a variety of artist needs and requirements.

Previous bookings have included a pop-up exhibition space, an artists studio, a workshop space, a photography and filming studio, a meeting venue, and an artists shop. We welcome all ideas on how you would like to use the space to further develop your practice and we have a variety of facilities and benefits to ensure you have a supportive and enriching experience.





Life drawing workshop



performance



Pop-up exhibition



Workshop space



Artists shop



Lecture space

“I was able to experiment and develop my ideas and pieces much more deeply. It was so beneficial as some of the ideas and plans I had thought would work didn’t and having the week allowed me to find solutions and develop the concepts I had.”

# The space

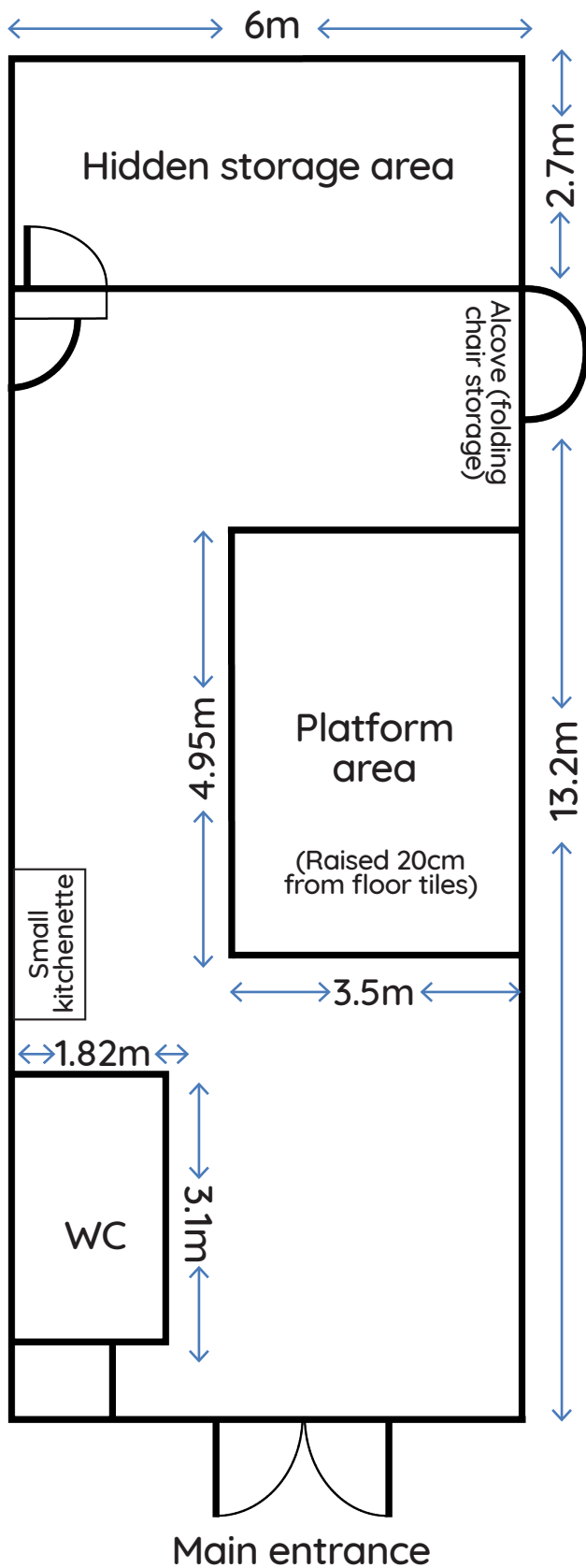

Testing Space floor plan

## Facilities & benefits

Testing Space offers a number of facilities and benefits which artists can make use of during their time at the studios.

- A vibrant studios complex with other visual artists
  - Accessible toilet
  - Small kitchenette
- Furniture including a desk, tables, chairs, and easels
- Wi-fi access and electric points
  - Projectors and screens
- Ramp for disabled access
  - Hidden storage area
- Heating/air conditioning
- Support from 'a space' arts

# The location

## Find us at:

Arches Studios,  
Captain's Place,  
Terminus Terrace,  
Southampton,  
SO14 3FE

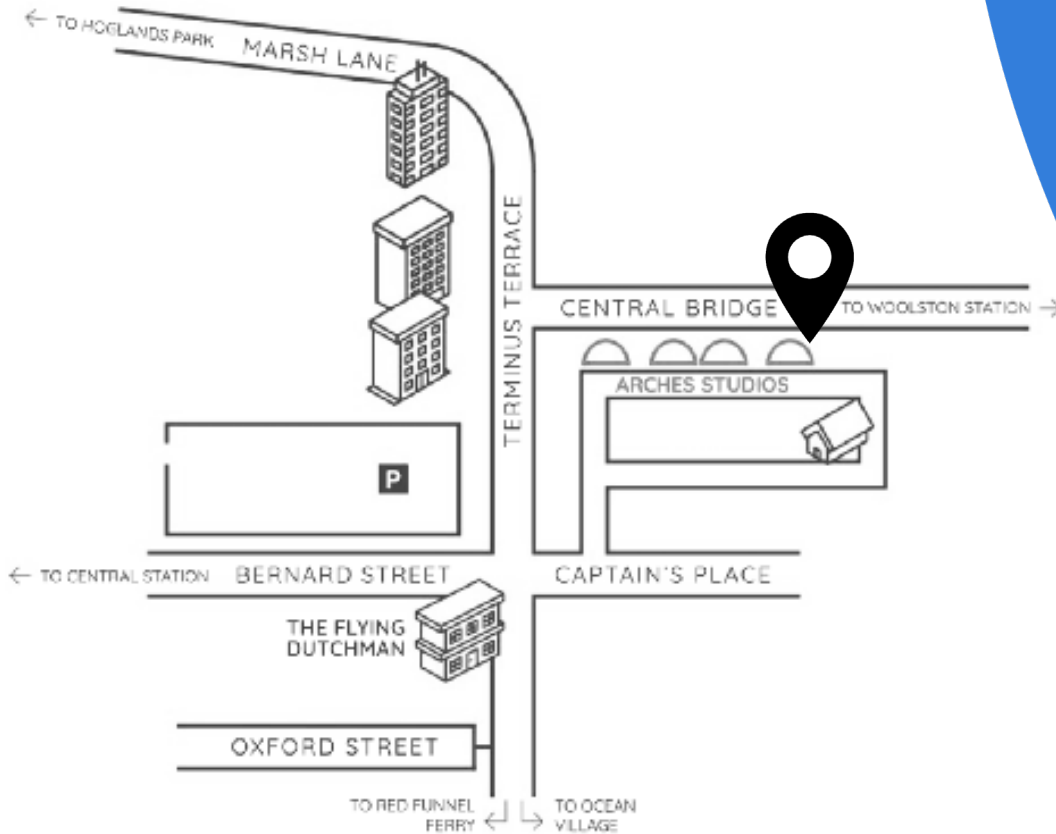

## Getting here

Testing Space is located in Arch 04 at the Arches Studios, Southampton, and is a short walk from the City Centre.

### On Foot

If you're approaching the Arches Studios from the city centre, walk down the High Street and take a left at Holyrood Church onto Bernard Street. Continue on Bernard Street then take a left onto Captain's Place. Follow the road around, the studios are located under Central Bridge.

### Public Transport

The nearest train station is Woolston, which is a 20 minute to from the studios.

Southampton Central is a 25 minute walk to the Studios.

# How to apply

To apply for the Testing Space, please fill out the online booking form with your name, contact details, and further information about your practice and how you intend to use the space during your booking. You can follow the link here - <https://bit.ly/3DtsUkO>

If you would like to make a booking using an alternative format, have any questions about Testing Space or want to arrange a visit to the space, please contact our Studios Manager Celeste at [celeste@aspacearts.org.uk](mailto:celeste@aspacearts.org.uk) for further information on how we can support your application.

## Access

As an organisation we actively look to reduce barriers for artists applying for our opportunities and commissions, and we are committed to being fair, accessible, transparent and inclusive.

We offer a range of access support for artists, including alternative formats for information we release and submissions we receive as well as an artist access fund; please contact us so that we can discuss your individual needs and provide appropriate support for your application or project. Please either email us on [enquiries@aspacearts.org.uk](mailto:enquiries@aspacearts.org.uk) or call **023 80 338 778**.



# About 'a space' arts

Established in 2000, 'a space' arts is a visual arts National Portfolio Organisation (NPO) which supports artists and inspires audiences through exhibitions, studios, professional development and by culturally reanimating lost spaces with arts and heritage. Through our portfolio of projects from providing studio space at the Arches Studios to our Artist Development programme which provides crucial resources for artists, we work to support visual artists and cultural audiences in and around Southampton to create a city where artistic communities can flourish.

'a space' arts can offer visual artists living or working in the SO postcode area a range of free support to help develop a sustainable career, including 1-to-1 meetings, information on funding, exhibition opportunities and peer networks. Find out more about how we can support you by visiting the 'a space' website.

[aspacearts.org.uk/artist-development](https://aspacearts.org.uk/artist-development)



a space  
arts



[godshousetower.org.uk](http://godshousetower.org.uk)



[aspacearts.org.uk](http://aspacearts.org.uk)



[ripesouthampton.org.uk](http://ripesouthampton.org.uk)

